

K2F280DN3W

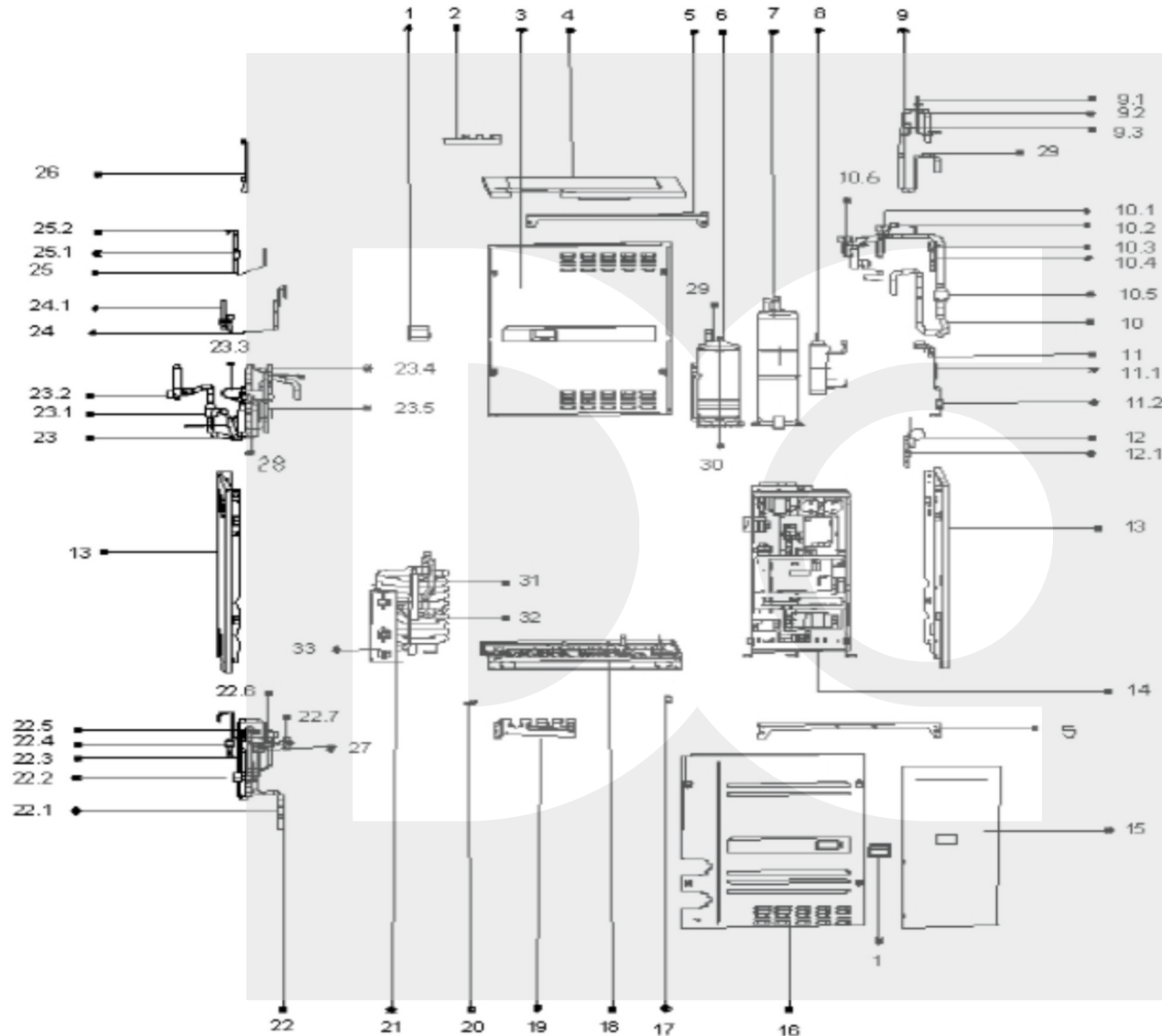

THERMO COMFORT

Sale

Factory

Product

MDVS-280(10)W/DRN1

CE-MDVS280(10)W/DRN1-8S1

220095/103290

K2F280DN3W

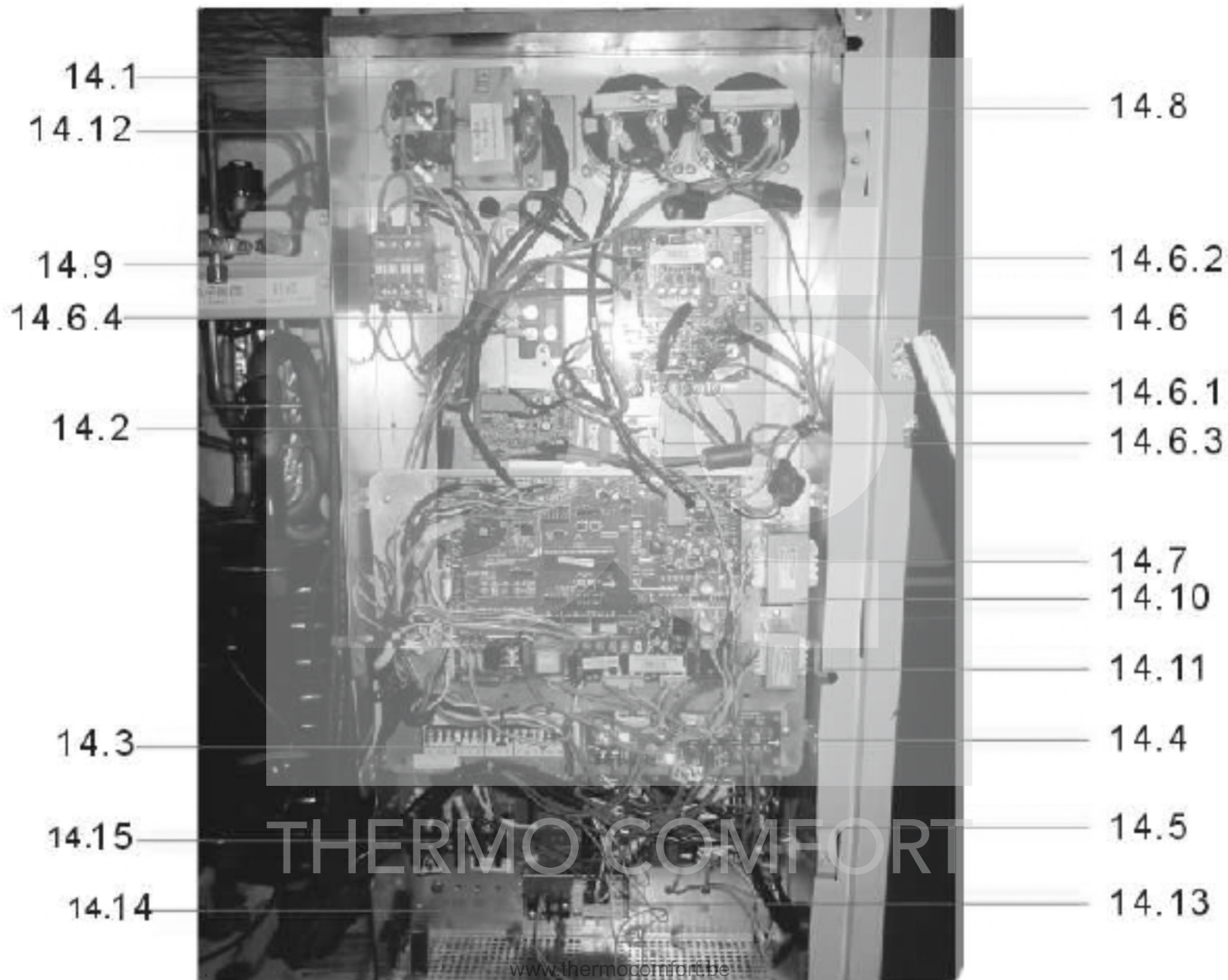

K2F280DN3W 220095/103290

Positie	Omschrijving	Code Engels	Leveranciersnummer	Extra Info
1	Handle		201148700009	
2	cover		201295100513	
3	Rear panel		201295100518	
4	Top plate welding parts		201295100514	
5	Beam		201295100512	
6	Compressor		201400400210	
7	Gas-liquid separator		201601100166	
8	Oil separator		201601100167	
9	Discharge pipe ass'y		201695101483	
9.1	Pressure sensor		202301300435	
9.2	Pipe joint		201601200212	
9.3	Pressure controller		202301820042	
10	Suction pipe ass'y		201695101476	
10.1	Solenoid valve		201600600081	
10.2	Pressure controller		202301820018	
10.3	Pressure sensor		202301300659	
10.4	Pipe joint		201601200212	
10.5	Strainer		201600900834	
10.6	Electromagnetic valve solenoid		201600600153	
11	Oil balance pipe ass'y		201695101474	
11.1	One way valve		201600800033	
11.2	Filter		201600900853	
12	oil return capillary components		201695101447	
12.1	Filter		201600900853	
13	Side plate ass'y		201295100517	
14	E-part box ass'y		203395190213	
14.1	Fan ass'y		201295100495	
14.2	Middle Wiring board ass'y		201319902807	
14.3	wiring board ass'y		201395100205	
14.4	Outdoor intermediate adapter plate ass'y		201395100276	

14.5	Power filtering board components		201395100277	
14.6	Water source conversion module ass'y		201395100316	
14.6.1	50A 1200V frequency converter module		202300701005	
14.6.2	Radiator		202301901152	
14.6.3	DC power supply filter board assembly		201319900914	
14.6.4	Three phase bridge		202300500326	
14.7	Main control board ass'y		201395190237	
14.8	Electrolytic capacitor		202300300468	
14.9	Contactora		202300850043	
14.10	Transformer		202300900109	
14.11	Power transformer		202300930257	
14.12	Reactor		202301000955	
14.13	Wire joint, 2p		202301450042	
14.14	Wire joint,2p		202301450043	
14.15	Wire joint, 4p		202301450112	
15	E-Part box cover		201295100519	
16	Front panel ass'y		201295100511	
17	Outlet plug		201195100392	
18	Base ass'y		201295100516	
19	Valve plate		201295100515	
20	Drain hose		201101020011	
21	Double-pipe heat exchanger		201700200001	
22	Expansion valve ass'y		201695101460	
22.1	Filter		201600900855	
22.2	Filter		201600900854	
22.3	One way valve		201600800033	
22.4	Filter		201600900857	
22.5	Electronic expansion valve		201601300571	
22.6	Electromagnetic valve		201600600080	
22.7	Low pressure valve		201600720193	
23	4-way valve ass'y		201695101452	
23.1	Strainer		201600900834	
23.2	low pressure valve		201600700080	

23.3	4-way valve		201600600110	
23.4	Unloading valve		201601600057	
23.5	One way valve		201600800833	
24	Oil balance valve components		201695101471	
24.1	Low pressure valve		201600700079	
25	Pipe joint ass'y		201695101450	
25.1	Filter		201600900853	
25.2	meter connector		201601200003	
26	Connection pipe ass'y		201695101448	
27	Electronic expansion valves wire		201601300572	
28	Four-way Valve Solenoid		201600600179	
29	Discharge temp sensor ass'y		202395020902	
30	Compressor electric heater		202403101240	
31	Condenser pipe temp.sensor ass'y		202301300753	
32	Temp sensor ass'y		202301300562	
33	Pipe temperature sensor assemblies		202301300526	

Sale	MDVS-280(10)W/DRN1
Factory	CE-MDVS280(10)W/DRN1-8S1
Product	220095/103290

THERMO COMFORT